

General information Cavity

Type series: AA

Dimensions and sectional view

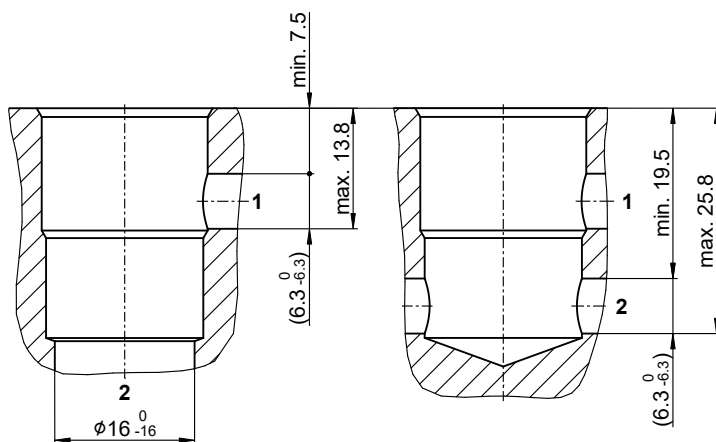
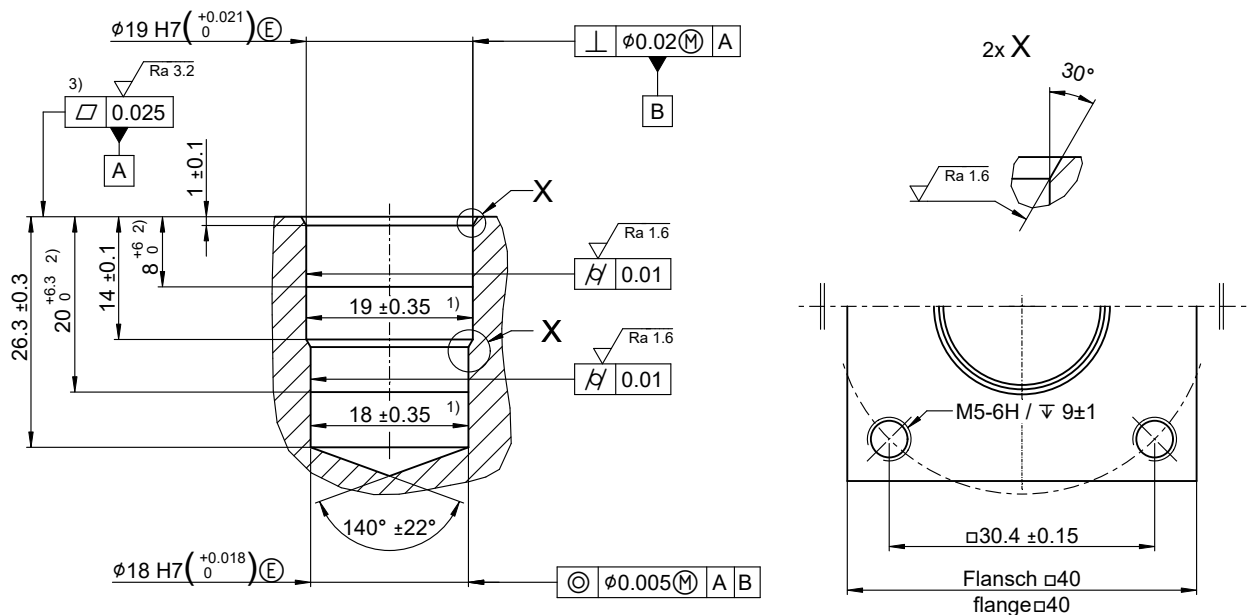

∇ Ra 6.3 (\checkmark)

- 1) Vorbearbeitungs- ϕ / pre-drilling diameters
- 2) Passungstiefe / minimum depth of specified diametral tolerance
- 3) $\phi 26 / \nabla 0,1 \pm 0,1$

Installation information

**ATTENTION!**

You must maintain the specified positional and diametral tolerances. To ensure trouble-free operation of the screw-in cartridges, we strongly recommend that pilot drilling, boring, reaming and cavity thread-cutting are always performed in one setup.

**NOTE!**

We offer form tool sets for sale or hire. For further information, see data sheet 400-P-040011.

**NOTE!**

Cavity type to factory standard.